

SEC. 35, T-10-N, R-6-W

TUTTLE SCHOOLS DISTRICT OFFICE  
515 E. MAIN STREET

GORDON WHITE LUMBER CO.  
517 E. MAIN STREET

| OKLAHOMA DEPARTMENT OF TRANSPORTATION |           |      |
|---------------------------------------|-----------|------|
| DESCRIPTION                           | REVISIONS | DATE |
|                                       |           |      |

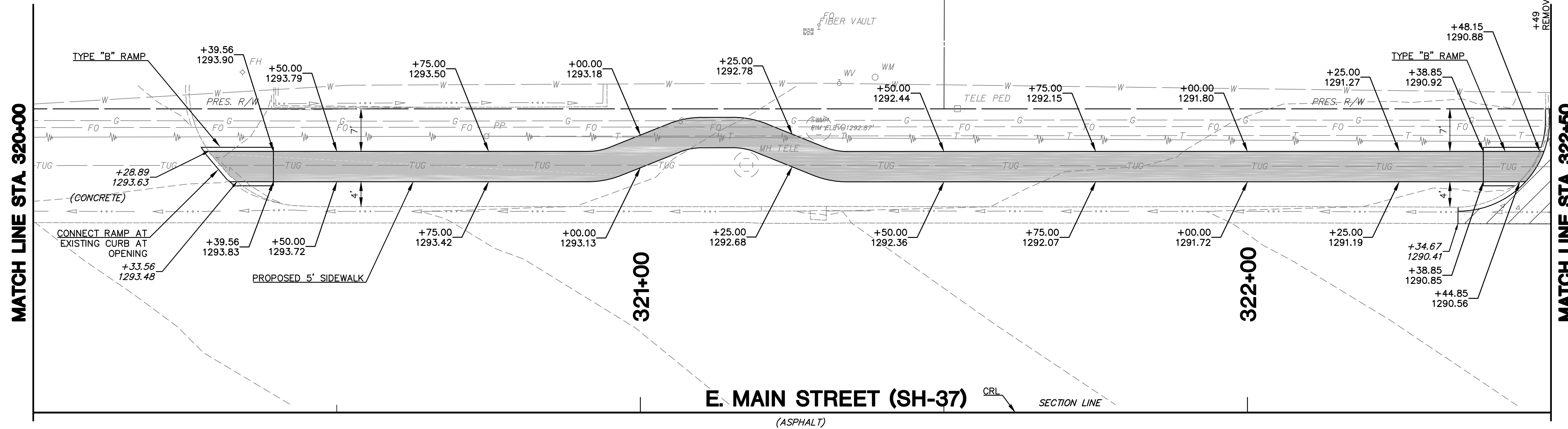

E. MAIN STREET (SH-37)  
(ASPHALT)

SEC. 2, T-9-N, R-6-W  
SEC. 35, T-10-N, R-6-W

+64 REMOVE 123 S.Y. EX. CONC. DRIVEWAY

+80 REMOVE 38 L.F. EX. CONC. CURB

GORDON WHITE LUMBER CO.  
517 E. MAIN STREET

EX. EASEMENT

+83 REMOVE 38 L.F. CURB

+95 REMOVE 25 S.Y. EX. CONC. DRIVEWAY

+07 REMOVE 39 L.F. CURB

DIANNA GARRETT REVOCABLE TRUST  
5 EDITH LANE

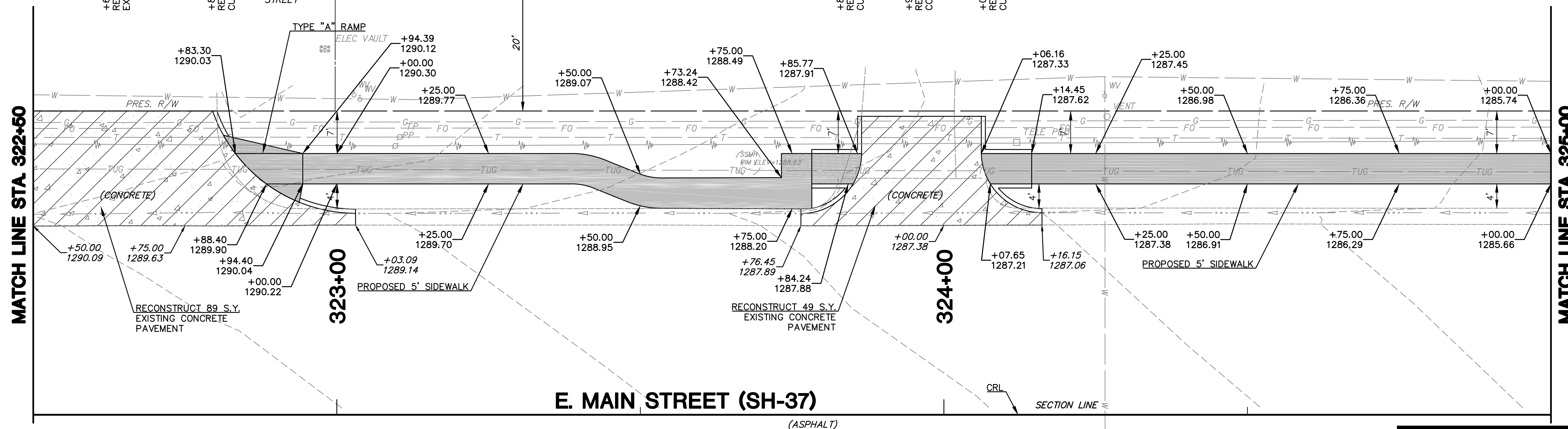

E. MAIN STREET (SH-37)  
(ASPHALT)

|         |     |        |
|---------|-----|--------|
| DESIGN  | LKN | 7/7/17 |
| DRAWN   | TJW | 7/7/17 |
| CHECKED | SKF | 7/7/17 |
| APPROV. | SKF | 7/7/17 |
| SQUAD   | CGE |        |

SIDEWALK NO. 3  
PLAN (5 OF 6)

GRADY COUNTY

JOB PIECE NO. 33001(04) SHEET NO. 20

SEC. 2, T-9-N, R-6-W

PLOTTED: Friday, July 07, 2017 @ 03:09PM  
 G:\Projects\17-058 Tuttle - TUG Sidewalk 2018\Drawings\17-058 SIDEWALK NO. 3 PLAN.dwg